

All bolts are to be fitted with a flat washer under the bolt head and a flat washer and spring washer under the nut, except for nyloc nuts which do not require a spring washer.

Some components may be hidden in drawing views for additional visibility but don't require removal for assembly. Components may vary depending on optional extras. some components may already be assembled.

The hydraulic pump is bolted to the pump bracket with 2x M10x20 bolts, the pump bracket is then bolted into the hydraulic box with 4x M12x35 bolts put in from the bottom upwards.

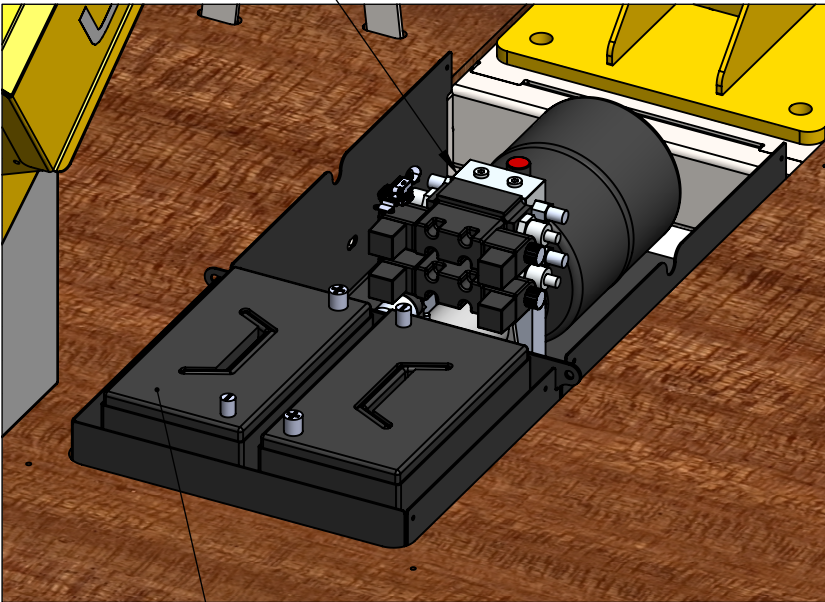

Rubber mat fitted under batteries, battery clamps hook through holes in the base of the battery box.

Fit the lower hydraulic ram with the appropriate ram pins, the pins are held in place by M8x25 bolts with flat washers and nyloc nuts.

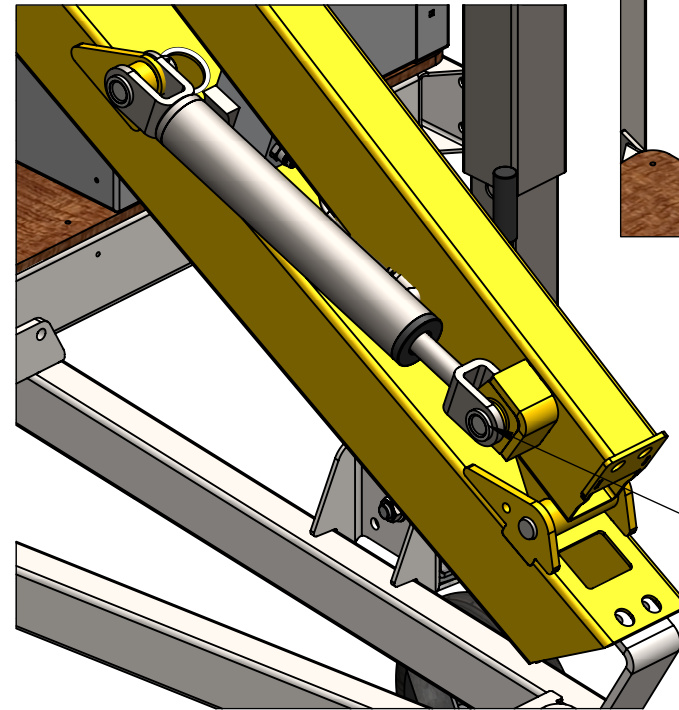

Fit the upper hydraulic ram with the appropriate ram pins, the pins are held in place by split pins.

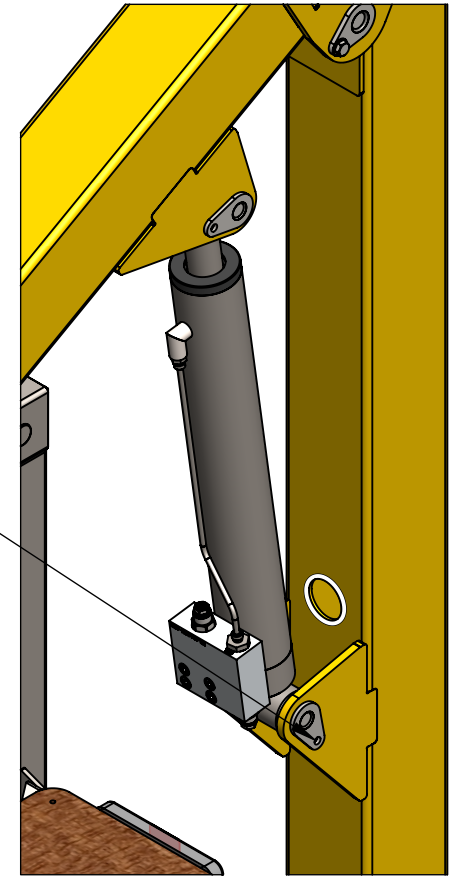

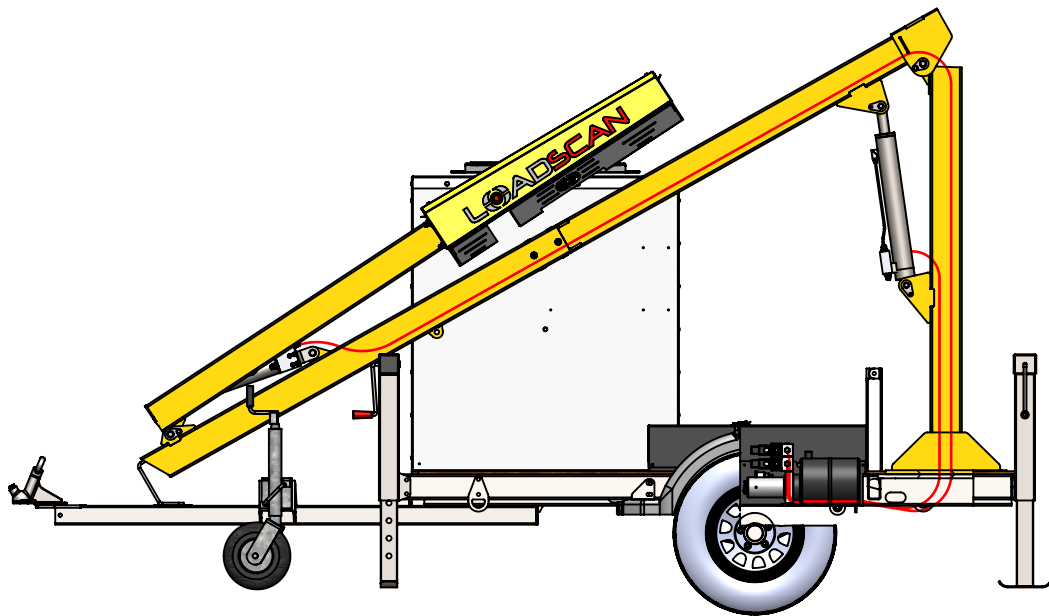

Feed the hydraulic hoses through the pole starting from the rams and feeding through into the back of the hydraulic box and onto the pump. Connect the hoses to the pump and rams as shown below.

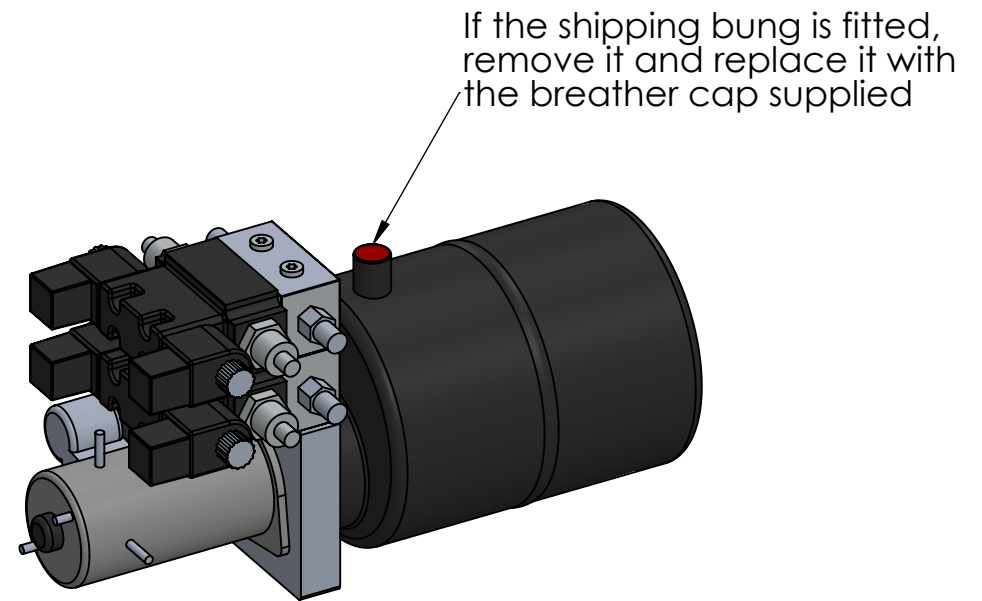
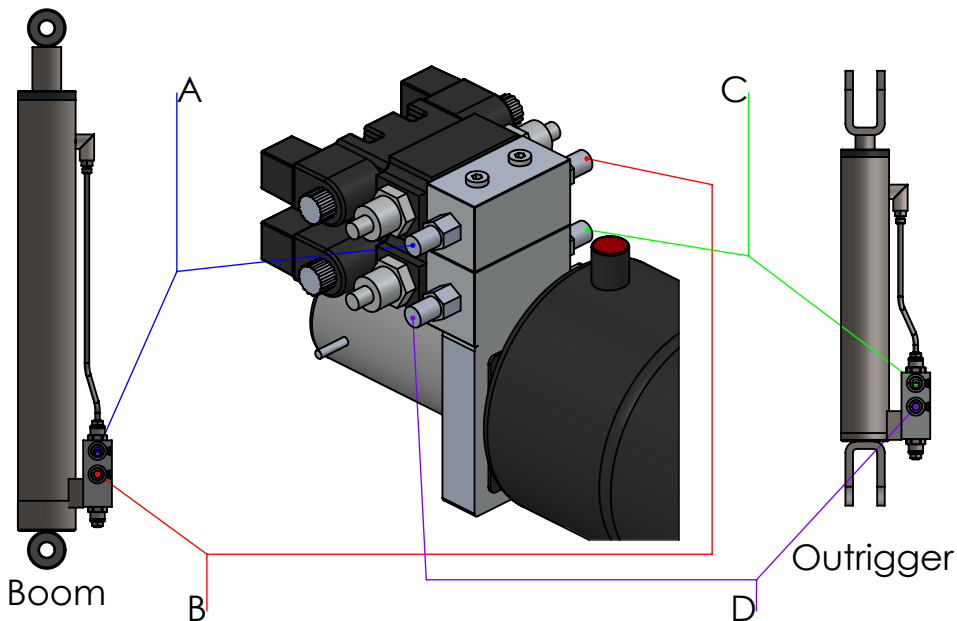

With the rams fully retracted, fill the oil reservoir up to 30mm from the top with Caltex Rando HD46 hydraulic oil, or equivalent.

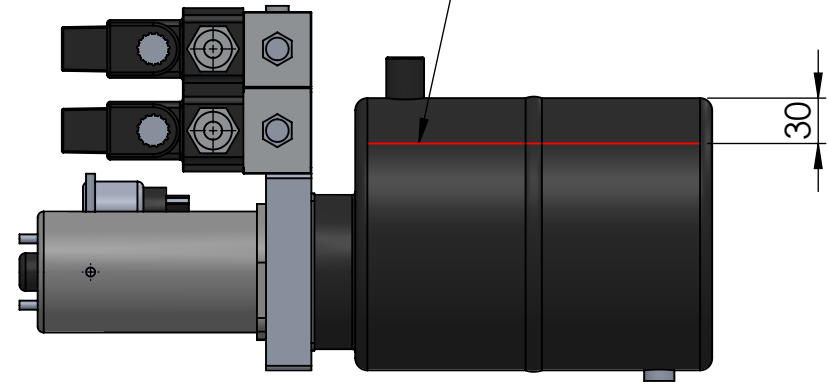

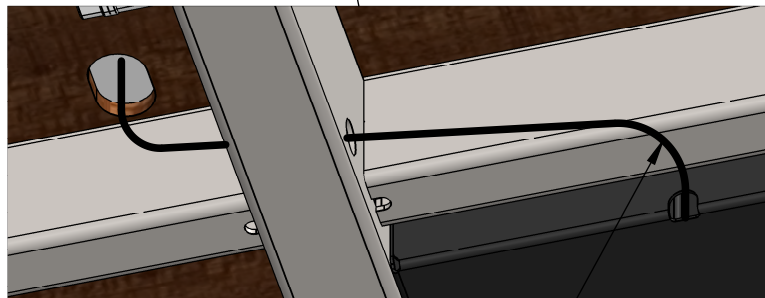
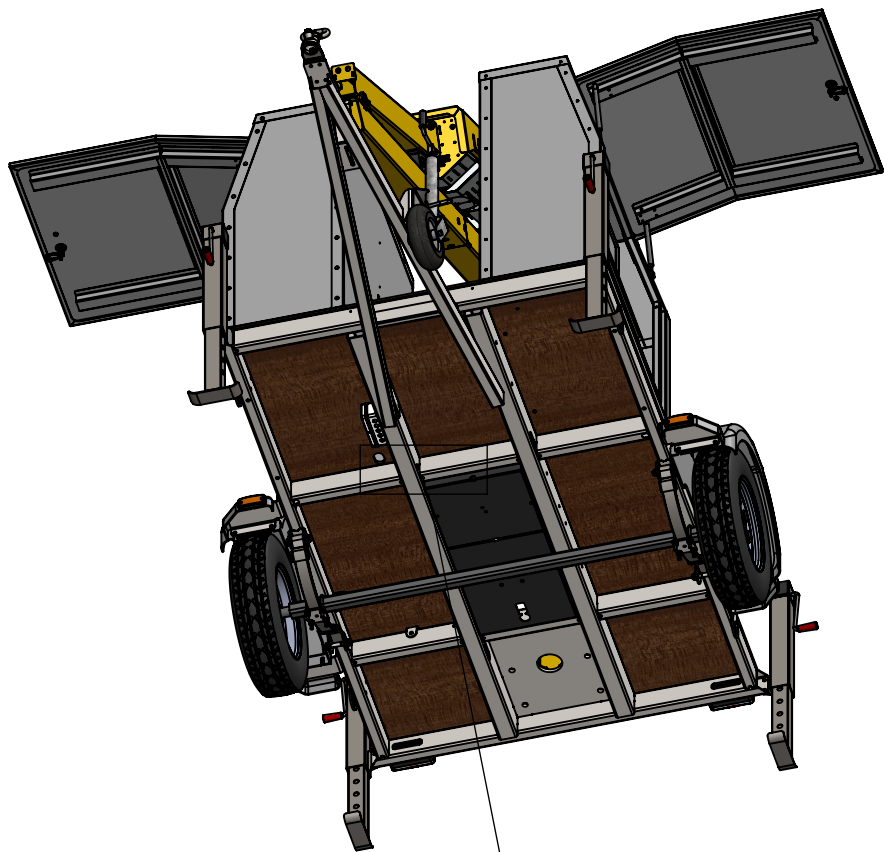

Feed the battery power cable out of the kiosk by going down through the hole in the decking timber, through the trailer frame and into the front of the battery box,

Orange and Black cables to hydraulic pump

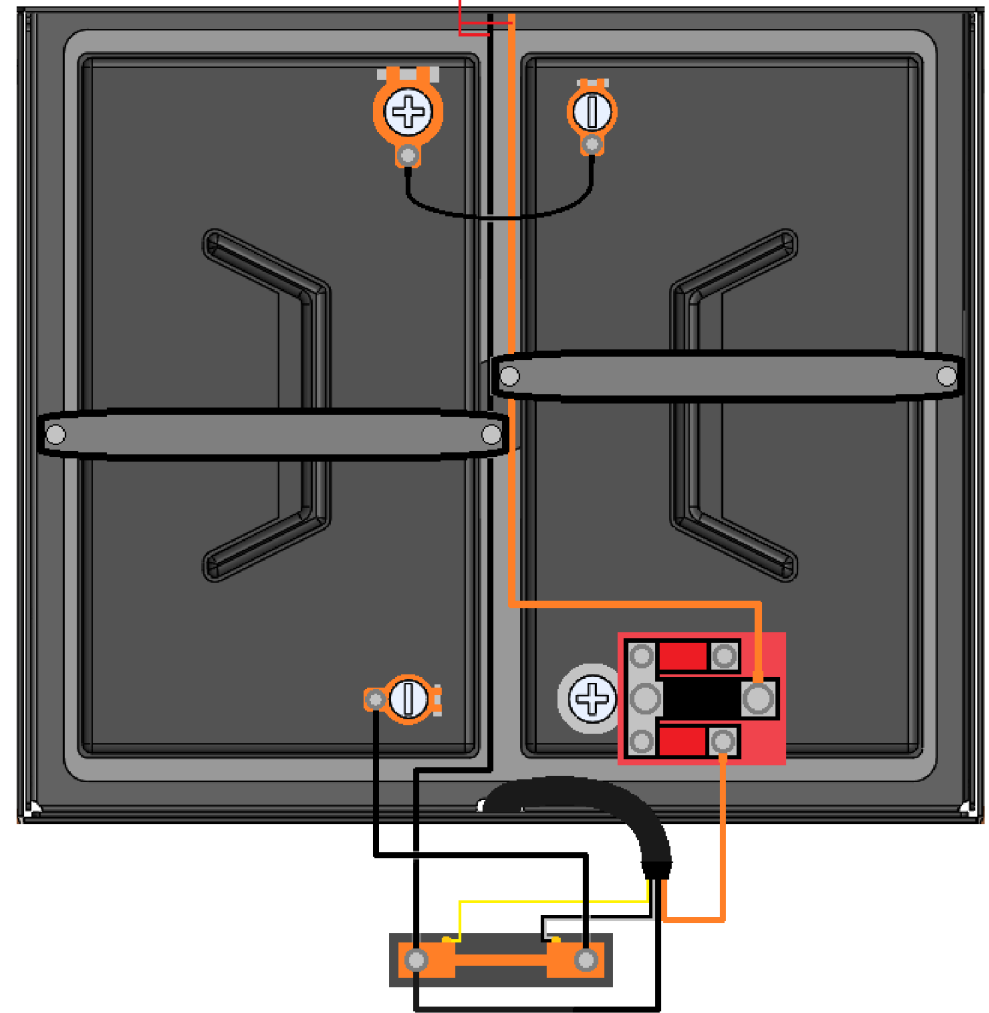

Cables should be connected inside the battery box by someone with competent electrical experience. Fit the orange cable to the empty 30Amp fuse. Fit the black cable from the power box to to the shunt on top of the black cable to the from the hydraulic box. The yellow wire and the black and white wires must be fitted to the shunt the correct way around otherwise the display will read incorrectly.

Recheck the oil level after the first full up and down cycle.

Last saved: 14/11/2022

Drawn by: Brad Webb

Dimensions in mm

Description:

Hydraulic assembly procedure

Drawing Number:

N/A

Revision:

A

Sheet: 3 of 3

LOADSCAN
LOAD VOLUME SCANNER

Comments: